

KJ-COMTECH N connectors are available with 50Ω and 75Ω impedance.

The N 75Ω connectors are suitable for applications up to 1.5 GHz. The screw-type coupling mechanism provides a sturdy and reliable connection. N 75Ω connectors are available in many different patterns.

Compatibility:

Centre conductors of N 75Ω connectors have a smaller diameter than those of the 50Ω and N 75Ω connectors are not intermateable.



Series N-75Ω

Microminiature Coaxial Connector

Technical Data

Material Data

Cable Connectors

Receptacles with Solder End

Adaptor within-Series

Termination

Microminiature Coaxial Connector

Description

KJ-COMTECH N connectors are available with 50Ω and 75Ω impedance.

The N 75Ω connectors are suitable for applications up to 1.5 GHz. The screw-type coupling mechanism provides a sturdy and reliable connection. N 75Ω connectors are available in many different patterns.

Compatibility:

Centre conductors of N 75Ω connectors have a smaller diameter than those of the 50Ω and N 75Ω connectors are not intermateable.

Contents

Microminiature Coaxial Connector	324
Technical Data	325
Material Data	325
Cable Connectors	326
Receptacles with Solder End	328
Adaptor within-Series	329
Termination	329

Interface Dimensions

Plug (Male)

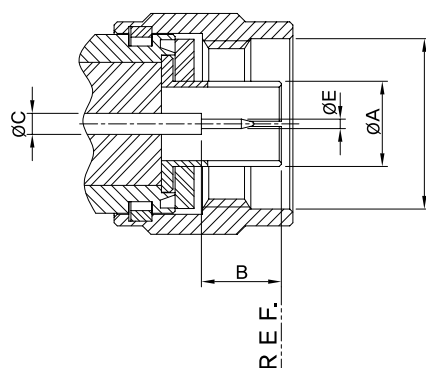

Jack (Female)

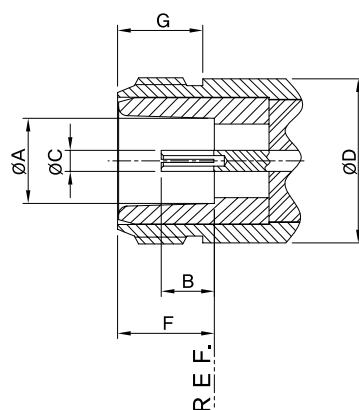

Interface Dimensions in mm/inch

	Plug (male)		Jack (Female)	
	Min.	Max.	Min.	Max.
A	-	8.68 / 0.342	8.03 / 0.316	8.13 / 0.320
B	5.33 / 0.210	5.84 / 0.230	4.75 / 0.187	5.26 / 0.207
C	-	2.00 / 0.079	-	2.00 / 0.079
D	16.00 / 0.630	-	-	15.93 / 0.627
E	1.00 / 0.039	1.05 / 0.041	5.33 / 0.210	-
F	-	-	9.04 / 0.356	9.19 / 0.362
G	-	-	6.76 / 0.266	-

Technical Data

Requirement

ELECTRICAL DATA

Impedance	75Ω
Frequency range	DC 1.5GHz
Dielectric withstanding voltage (at sea level)	2.5 kV rms, 50 Hz
Working voltage (at sea level)	≤ 1.0 kV rms, 50 Hz
Insulation resistance	≥ 5 · 10 ⁸ MΩ
Contact resistance	
- Center contacts	≤ 1.0mΩ
- Outer contacts	≤ 1.0mΩ

Specification

TEST REQUIREMENTS

MECHANICAL DATA

Coupling nut torque	
- recommended	0.68Ncm ~ 1.13Ncm / 6.0 in. lbs ~ 0.0 in. lbs
- proof torque	1.70 Ncm / 15.0 in. lbs
Coupling nut retention force	≥ 450 N / 101.2 lbs
Contact captivation	≥ 28 N / 6.3 lbs
Durability (matings)	≥ 500

TEST REQUIREMENTS

Material Data

Connector Part	Material		Plating
	Male	Female	
PIN	Brass	Beryllium-Copper	Gold
INSULATOR	PTFE	PTFE	-
BODIES	Brass	Brass	Nickel or Silver
SPRING RING	Stainless-Steel	-	-
GASKET	Silicone-Rubber	-	-
INSERT	Brass	Brass	Nickel or Silver
BACK NUT	Brass	Brass	Nickel
CRIMP FEMALE	Brass	Brass	Nickel

Cable Connectors

● **Straight Cable Plugs(male)**

For flexible cables
Cable entry clamp

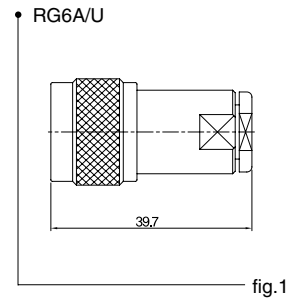

Fig	Type	Code		Cable Goup (example)	Plating			AS-In	Note
		Old Code	New Code		Pin	Body	Back Nut		
1	N75-P3-RG6/U	K347-006-000	CN3511X11-001-1/1	X11 RG6A/U	Gold	Nickel	Nickel		

For flexible cables
Cable entry crimp
Cable contact soldered

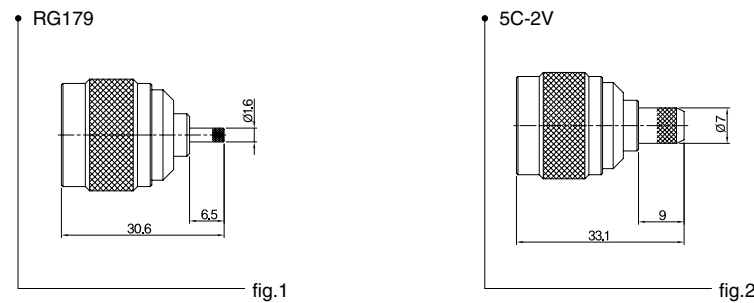

Fig	Type	Code		Cable Goup (example)	Plating			AS-In	Note
		Old Code	New Code		Pin	Body	Crimp		
1	N75-PC-179	K347-001-000	CN3511X04-001-1/1	X04 RG179	Gold	Nickel	Nickel		
2	N75-PC-5C-HFB	K347-002-000	CN3511X34-001-1/1	X10 5C-2V	Gold	Nickel	Nickel		

● **Right Angle Cable Plugs(male)**

For flexible cables
Cable entry clamp
Centre contact soldered

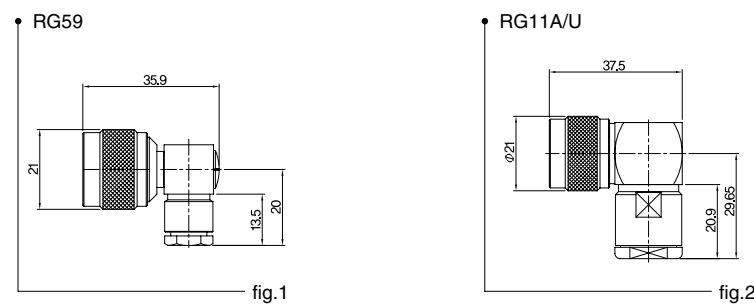

Fig	Type	Code		Cable Goup (example)	Plating			AS-In	Note
		Old Code	New Code		Pin	Body	Coupling		
1	N75-LP3-59	K347-115-000	CN3531X09-001-1/1	X09 RG59	Gold	Nickel	Nickel		
2	N75-LP3-RG11	K347-116-000	CN3531X18-001-1/1	X18 RG11A/U	Gold	Nickel	Nickel		

● **Straight Cable Jacks(female)**

For flexible cables
Cable entry clamp

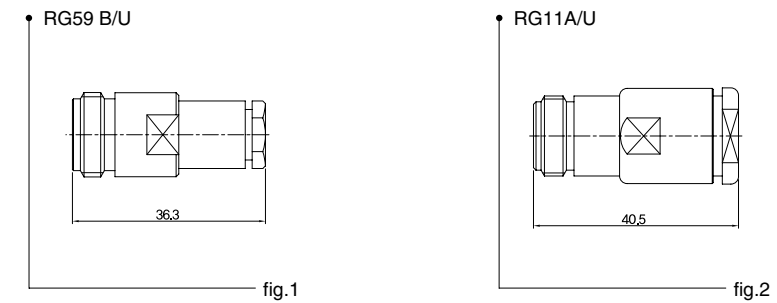

Fig	Type	Code		Cable Goup (example)	Plating			AS-In	Note
		Old Code	New Code		Pin	Body	Back Nut		
1	N75-J3-59	K347-220-000	CN3512X09-001-1/1	X09 RG59 B/U	Gold	Nickel	Nickel		
2	N75-J3-RG11	K347-221-000	CN3512X18-001-1/1	X18 RG11A/U	Gold	Nickel	Nickel		

● **Straight Bulkhead Cable Jacks(female)**

For flexible cables
Cable entry clamp
Centre contact soldered
With panel seal

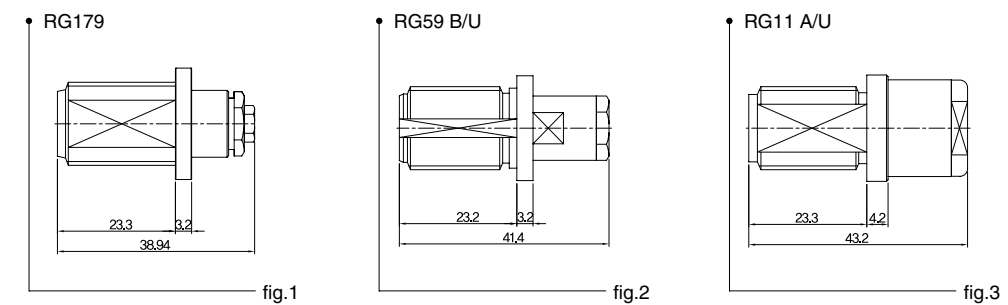

Fig	Type	Code		Cable Goup (example)	Plating			AS-In	Note
		Old Code	New Code		Pin	Body	Back Nut		
1	N75-BJ-3-179	K347-331-000	CN3522X04-001-1/1	X04 RG179	Gold	Nickel	Nickel		
2	N75-BJ-3-59	K347-333-000	CN3522X09-001-1/1	X09 RG59 B/U	Gold	Nickel	Nickel		
3	N75-BJ-3-RG11	K347-332-000	CN3522X18-001-1/1	X08 RG11 A/U	Gold	Nickel	Nickel		

● Straight Panel Cable Jacks (female)

For flexible cables
Cable entry clamp
Centre contact soldered

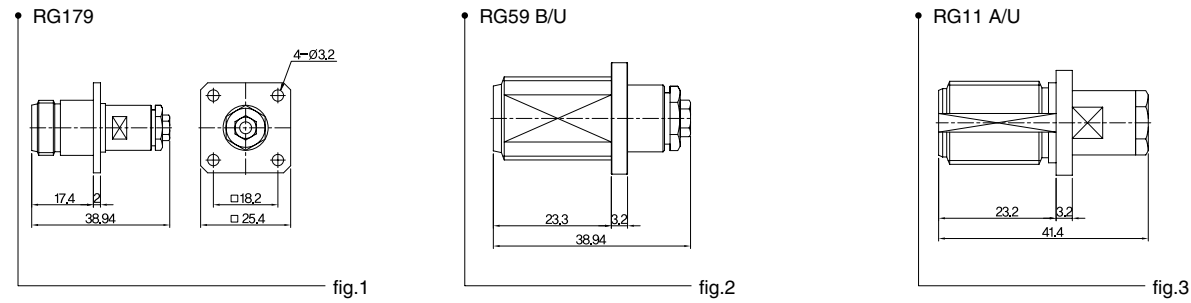

Fig	Type	Code		Cable Goup (example)	Plating			AS-In	Note
		Old Code	New Code		Pin	Body	Back Nut		
1	N75-J-H4-3-179	K347-225-000	CN3544X04-001-1/1	X04	RG179	Gold	Nickel	Nickel	
2	N75-J-H4-3-59	K347-222-000	CN3544X09-001-1/1	X09	RG59 B/U	Gold	Nickel	Nickel	
3	N75-J-H4-3-RG11	K347-223-000	CN3544X18-001-1/1	X18	RG11 A/U	Gold	Nickel	Nickel	

Receptacle with Solder End

● Flange Mount Jack (female)

Panel mounted

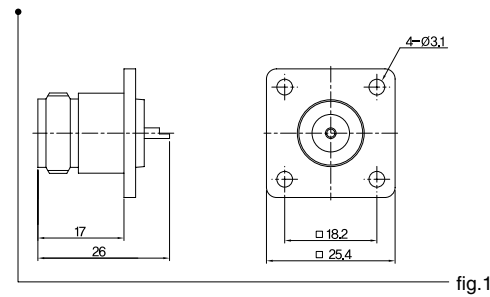

Fig	Type	Code		Plating		Mounting Hole	AS-In	Note
		Old Code	New Code	Pin	Body			
1	N75-J-H4-R	K347-410-000	CN3544000-001-1/1	Gold	Nickel	ML87		

Adaptors within Series

● Straight Adaptors

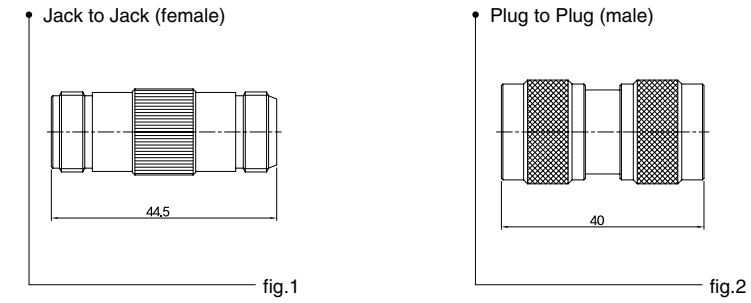

Fig	Type	Code		Plating			AS-In	Note
		Old Code	New Code	Pin	Body	Coupling		
1	N75-A-JJ	K347-702-000	AD3512-001-1/1	Gold	Nickel	-		
2	N75-A-PP	K347-701-000	AD3511-001-1/1	Gold	Nickel	Nickel		

Terminations

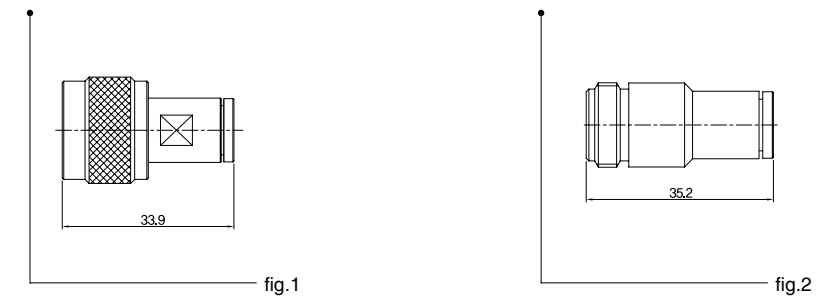
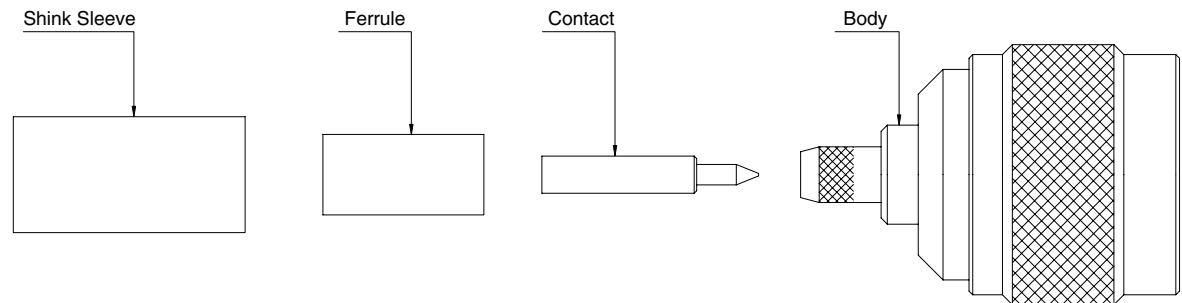

Fig	Type	Code		V.S.W.R DC~1.5GHz	Plating			Note
		Old Code	New Code		Pin	Body	Back Nut	
1	N75-P-TERM	K347-911-000	CN3591-001-1/1	≤ 1.2	Gold	Nickel	Nickel	No Chain
2	N75-J-TERM	K347-912-000	CN3594-001-1/1	≤ 1.2	Gold	Nickel	Nickel	No Chain

● STANDARD CRIMP



● CONNECTORS

- K345-001
- K345-002

1. Insert the ferrule and the heat shrink sleeve into the cable and strip off the outer seath.

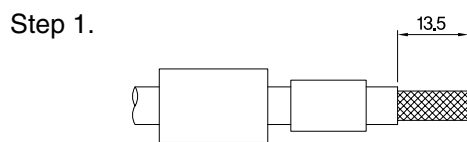

2. After striping off the out conductor and the inner conductor as shown in the diagram.

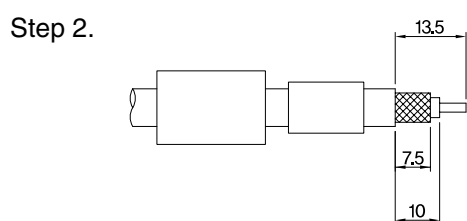

3. Insert the center contact into the cable and solder the solder point.

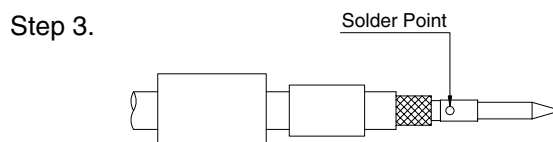

4. Insert the center contact and the dielectric core of the cable into the body the be weapped with the above section of the body as shown in the diagram. After done, push the ferrule into it and crimp with the crimp tool.

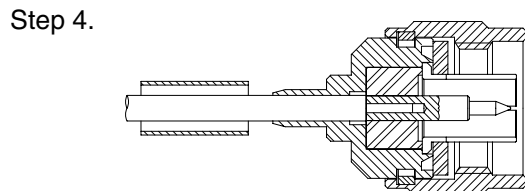

5. Push the heat shrink sleeve to the ferrule finished crimping and contract by heating.

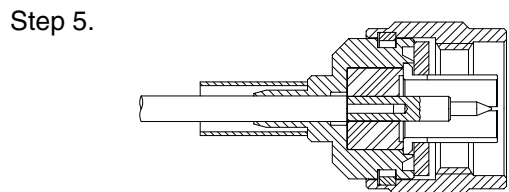

● STANDARD CLAMP

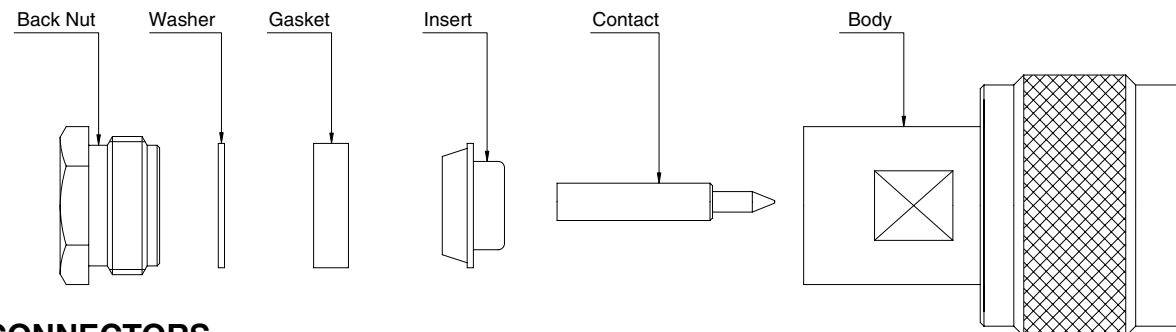

● CONNECTORS

- K345-003
- K345-004
- K345-005
- K345-006
- K345-007
- K345-008
- K347-009
- K347-010

1. Cut the cable as much as required.

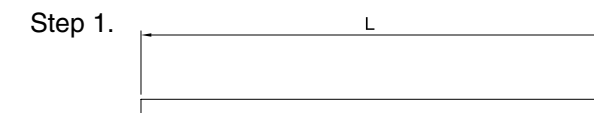

2. Insert the back nut, the washer, the gasket, the clamp into the cable in the order named and strip off the out seath.

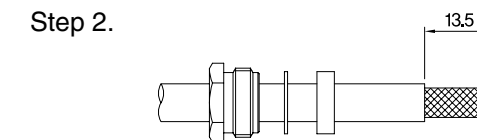

3. After stripping off the Inner conductor and the outer conductor as shown in the diagram.

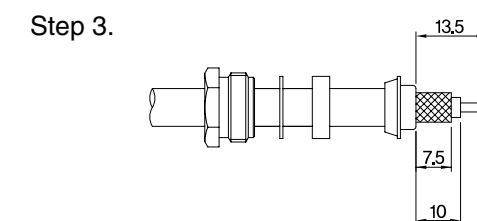

4. Attach the outer conductor to the above of the clamp putting it to the solder point of the Inner contact and solder it.

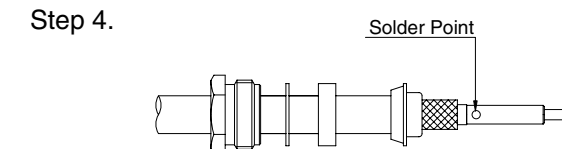

5. Insert the cable, the washer, he gasket back nut into the body and screw it.

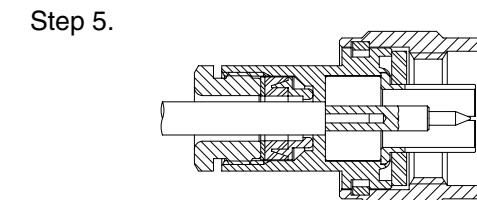

● RIGHT ANGLE CRIMP

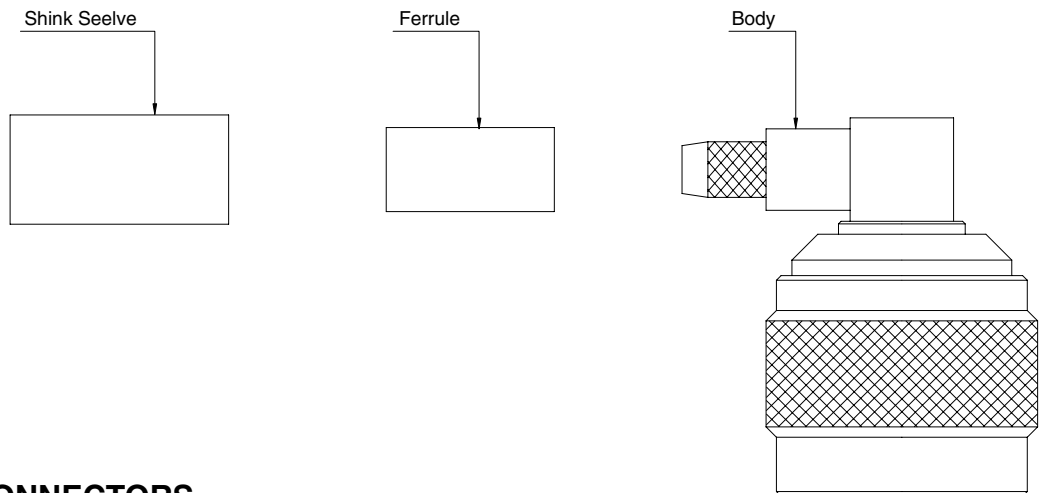

● CONNECTORS

- K345-113
- K345-114

1. After inserting the ferrule and the heat shrink sleeve into the cable, strip off the outer seath.

2. After stripping off the out conductor and the inner conductor as shown in the diagram, prepare the Inner conductor to solder.

3. Insert the cable and the ferrule into the body.

4. After crimping in the crimp zone and contracting the shrink sleeve, seal up the insulator, the cap in the order named.

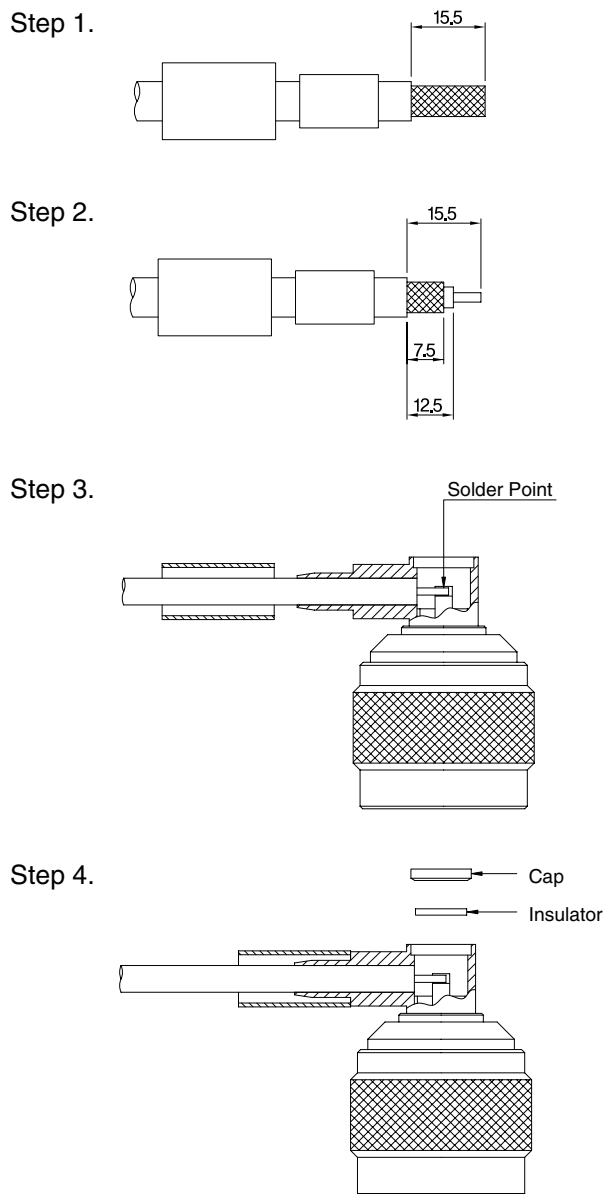

● RIGHT ANGLE CLAMP

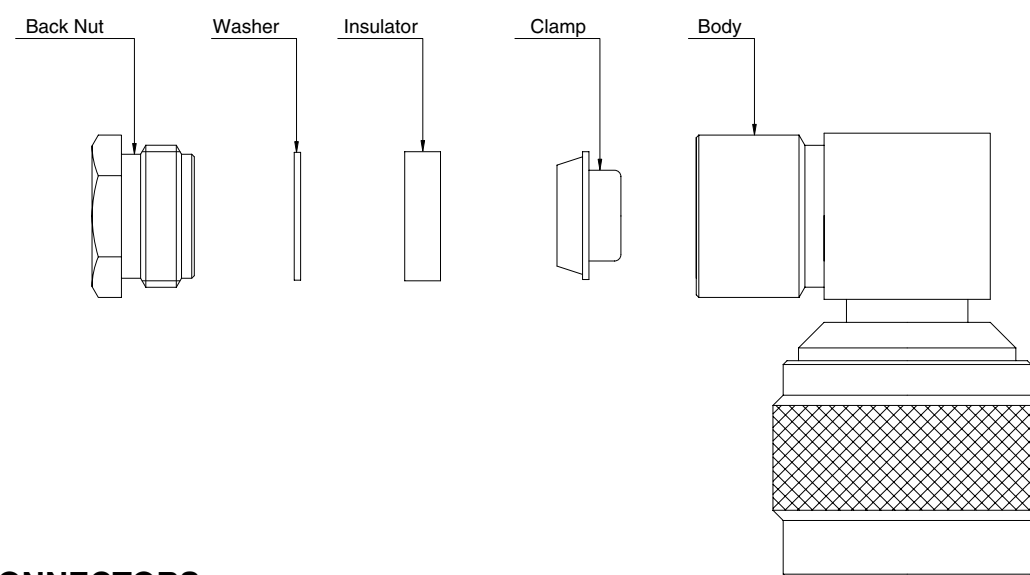

● CONNECTORS

- K345-111
- K345-112

1. Cut the cable as much as required.

2. Insert the back nut, the washer, the gasket, the clamp in the order named and strip off the out seath.

3. Attach the outer conductor to the above of the clamp equally putting it to the solder point of the inner contact and then solder it.

4. Insert the cable, the washer, the gasket back unt into the body and screw the back nut.

